

Steering Components

- Handle bar
- Spacer / Headset Cap
- Stem
- Pedal
- Bar End Plug
- Cable Kit / InnerWire
- Cable Donuts / C Clip
- Bolts & Screws



PAN TAIWAN ENTERPRISE CO., LTD.

 <https://oem.pantaiwan.com.tw>  oem@pantaiwan.com.tw

STEERING COMPONENTS

Handle Bar



ROAD

BB29001

Material: AL 6061-T6 / AL 7050-T73

Bar Center: 31.8 mm

Width 400 ~ 440 mm

Drop 135 mm

Reach 65 mm

ROAD

BB29002

Material: AL 6061-T6 / AL 7050-T73

Bar Center: 31.8 mm

Width 400 ~ 440 mm

Drop 145 mm

Reach 90 mm



ROAD

BB29003

Material: AL 6061-T6 / AL 7050-T73

Bar Center: 31.8 mm

Width 400 ~ 440 mm

Drop 145 mm

Reach 90 mm

ROAD

BB29004

Material: AL 6061-T6 / AL 7050-T73

Bar Center: 31.8 mm

Width 380 ~ 440 mm

Drop 150 mm

Reach 71 mm



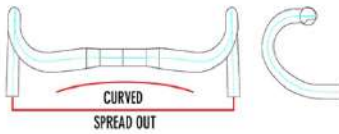

ROAD
BB29005

Material: AL 6061-T6
Bar Center: 31.8 mm
Width 380 ~ 440 mm
Drop 151 mm
Reach 91 mm

ROAD
BB29006

Material: AL 6061-T6 / AL 7050-T73
Bar Center: 31.8 mm
Width 400 ~ 440 mm
Drop 140 mm
Reach 75 mm

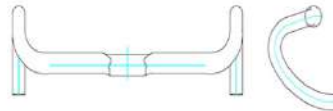

ROAD
BB29007

Material: AL 6061-T6 / AL 7050-T73
Bar Center: 31.8 mm
Width 400 ~ 440 mm
Drop 130 mm
Reach 75 mm

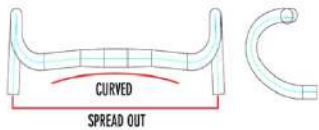

ROAD
BB29008

Material: AL 6061
Barbore: 31.8 mm
Width 380 / 400 / 420 / 440 mm
Drop 120 mm
Reach 70 mm



STEERING COMPONENTS

Handle Bar



CARBON ROAD

BB29501

Material: Monocoque 3 K & UD Carbon

Bar Center: 31.8 mm

Width 400 / 420 / 440 mm

Drop 128 mm

Reach 85 mm

MTB

BB29101

Material: AL 6069-T6

Bar bore: 31.8 mm

Width: 620 / 640 / 660 mm

Rise: 15 mm

Backsweep: 7°

Upsweep: 2°



MTB

BB29102

Material: AL 6061-T6

Bar bore: 35 mm

Rise: 0 mm

Width: 600 ~ 680 mm

Backsweep: 7°



MTB

BB29101

Material: AL 6061-T6 / AL 7050-T74

Bar bore: 35 mm

Rise: 38 mm

Width: 710 / 750 mm

Taper: 2.6 / 1.8 mm

Backsweep: 8°

Upsweep: 5.5°



MTB

BB29104

Material: AL 6061-T6 / AL 7050-T74

Bar bore: **35 mm**

Rise: 12 / 25 / 38 mm

Width: 710 / 750 mm

Backsweep: 8°

Upsweep: 5.5°



MTB

BB29105

Material: AL 6061-T6

Bar bore: 31.8 mm

Rise: 7 mm

Width: 560 ~ 680 mm

Backsweep: 7°

Thickness: 1.6 / 1.2 mm



MTB

BB29106

Material: Scandium

Bar bore: 25.4 / 31.8 mm

Rise: 0 mm

Width: 560 / 580 mm

Backsweep: 6°



MTB

BB29107

Material AL 6061-T6

Bar bore : 25.4 mm (3.0 / 1.4)

31.8 mm (2.4 / 1.4)

Rise : 25mm

Width: 600 / 680 mm

Backsweep: 7°



STEERING COMPONENTS

Handle Bar



FIXIE **BB29201**

Material: Aluminum Alloy 6061
Barbore: 25.4 / 26.0 / 31.8 mm
Width 400 / 420 / 440 mm

FIXIE **BB29202**

Material: Aluminum Alloy 6061
Barbore: 25.4 / 26.0 / 31.8 mm
Width 400 / 420 / 440 mm



FIXIE **BB29203**

Material: Aluminum Alloy 6061
Barbore: 25.4 / 26.0 mm
Width 380 / 400 mm



FIXIE **BB29204**

Material: Aluminum Alloy 6061
Barbore: 25.4 / 26.0 / 31.8 mm
Width 400 / 420 / 440 mm





URBAN
BB29301

Material: Aluminum Alloy 6061
Barbore: 25.4 / 31.8 mm
Width: 580 mm

URBAN
BB29304

Material: Alloy 6061
Barbore: 31.8 mm
Width: 660 mm
Rise: 13 mm
Backsweep: 45°



URBAN
BB29305

Material: Alloy / Steel
Barbore: 25.4 / 26.0 mm
Width: 520 / 590 mm
Rise: 48 mm

URBAN
BB29307

Material: Alloy / Steel
Barbore: 25.4 mm
Width: 515 mm
Rise: 50 mm



STEERING COMPONENTS

Handle Bar



BMX **BB29401**

Material: Steel / Co-Mo

Barbore: 22.22 mm

Width: 635~736 mm

Rise: 180~228 mm

BMX **BB29402**

Material: Steel / Co-Mo

Barbore: 22.22 mm

Width: 670 mm

Rise: 190 mm



BMX **BB29403**

Material: Aluminum 6061 / Co-Mo

Barbore: 31.8 mm

Width: 680~750 mm

Rise: 180~210 mm



BMX **BB29404**

Material: Steel

Barbore: 22.2 mm

Width: 635 mm

Rise: 190 mm





BMX
BB29405

Material: Steel / Cr-Mo
Barbore: 22.2 mm
Width: 630 ~ 711 mm
Rise: 170 / 200 / 230 mm

BMX
BB29406

Material: Steel / Cr-Mo
Barbore: 22.2 mm
Width: 635 mm
Rise: 177 mm



BMX
BB29407

Material: Steel / Cr-Mo
Barbore: 22.2 mm
Width: 675 ~ 720 mm
Rise: 194 ~ 200 mm



BMX
BB29408

Material: Steel
Barbore: 22.2 mm
Width: 420 ~ 710 mm
Rise: 110 / 127 / 165 / 193 mm



STEERING COMPONENTS

Headset Caps



BB11001

HEADSET CAP

Weight 20g



BB11002

HEADSET CAP

Weight 19g



BB11003

HEADSET CAP

Weight 19g



BB11004

HEADSET CAP

Weight 20g



BB11005

HEADSET CAP

Weight 19g



BB11006

MAGNETIC HEADSET CAP

Weight 21g



BB11007

HEADSET CAP

Height 10 / 15 / 20 mm



BB11008

HEADSET CAP

Weight 20g



BB11011

HEADSET CAP

Weight 19g



BB11001-321

Ti HEADSET CAP

Weight 21g



BB11005-323

HEADSET CAP

Weight 19g



BB11012

2 PIECE HEADSET

CAP Weight 18g

Custom Cap Service for Bike shops

Top Caps with your logo laser etched makes you shop more professional and stylish.

BB11016

Top Cap For Garmin



Spacer



BB12001

ALUMINUM SPACER

Material AL 6061
Size 1-1/8"
Height 3/5/10/15/20mm
Color Anodized



BB12002

ALUMINUM SPACER

Material AL 6061-T6
Size 1-1/8"
Height 3/5/10/15/20mm
Color Anodized



BB12003

ALUMINUM SPACER

Material AL 6061-T6
Size 1-1/8"
Height 3/5/10/15/20mm
Color Anodized



BB12004

ALUMINUM SPACER

Material AL 6061
Size 1-1/8"
Height 3/5/10/15/20mm
Color Anodized



BB12005

CARBON FIBER SPACER

Material Carbon Fiber
Size 1-1/8"
Height 3/5/10/15/20mm
Texture 3K / UD / Marble
Finish Glossy / Matt



BB12006

CARBON FIBER SPACER

Material Carbon Fiber
Size 1-1/8"
Height 3/5/10/15/20mm
Texture 3K / UD / Marble
Finish Glossy / Matt



STEERING COMPONENTS

Stem



BB21001

Material: AL-7050

Extension: 50~130mm

Calibre: $\varnothing 28.6 \times 31.8$ mm

Height: 40mm

Angle: $6^\circ / 84^\circ$

Weight: 115g of ext. 100mm



BB21002

Material: AL-7050

Extension: 80~130mm

Calibre: $\varnothing 28.6 \times 31.8$ mm

Height: 42mm

Angle: $6^\circ / 84^\circ$

Weight: 118g of ext. 100mm



BB21003

Material: AL-2014

Extension: 60~130mm

Calibre: $\varnothing 28.6 \times 25.4/26.0$ mm

Height: 40mm

Angle: $6^\circ / 84^\circ$

Weight: 120g of ext. 100mm



BB21004

Material: AL-2014

Extension: 80~130mm

Calibre: $\varnothing 28.6 \times 31.8$ mm

Height: 40mm

Angle: $6^\circ / 84^\circ$

Weight: 137g of ext. 100mm



BB21005

Material: AL-6061

Extension: 50~130mm

Calibre: $\varnothing 28.6 \times 31.8$ mm

Height: 45mm

Angle: $7^\circ / 83^\circ$

Weight: 165g of ext. 100mm



BB21006

Material: AL-6061

Extension: 50~130mm

Calibre: $\varnothing 28.6 \times 31.8$ mm

Height: 40mm

Angle: $6^\circ / 84^\circ$

Weight: 147g of ext. 100mm



BB21007

Material: AL-6061

Extension: 50~90mm

Calibre: $\varnothing 28.6 \times 31.8$ mm

Height: 40mm

Angle: $\pm 17^\circ$

Weight: 118g of ext. 90mm



BB21008

Material: AL-6061

Extension: 50/54/58mm

Calibre: $\varnothing 28.6 \times 22.2$ mm

Height: 30mm

Angle: 0°

Weight: 235g



BB21009

Material: AL-6061

Extension: 50mm

Calibre: $\varnothing 28.6 \times 22.2$ mm

Height: 30mm

Angle: 0°

Weight: 243g



BB21010

Material: Alloy
 Extension: 40mm
 Calibre: $\phi 28.6 \times 22.2\text{mm}$
 Height: 30mm
 Angle: 0°
 Weight: 234g



BB21011

Material: Alloy
 Extension: 50mm
 Calibre: $\phi 28.6 \times 22.2\text{mm}$
 Height: 30mm
 Angle: 0°
 Weight: 247g



BB21012

Material: Alloy
 Extension: 50mm
 Calibre: $\phi 28.6 \times 22.2\text{mm}$
 Height: 30mm
 Angle: 0°
 Weight: 245g



BB21013

Material: Alloy
 Extension: 50mm
 Calibre: $\phi 28.6 \times 22.2\text{mm}$
 Height: 30mm
 Angle: 0°
 Weight: 240g



BB21014

Material: Alloy
 Extension: 50mm
 Calibre: $\phi 28.6 \times 22.2\text{mm}$
 Height: 30mm
 Angle: 0°
 Weight: 235g



BB21015

Material: Alloy
 Extension: 50mm
 Calibre: $\phi 28.6 \times 22.2\text{mm}$
 Height: 30mm
 Angle: 0°
 Weight: 243g

Right-Hand Tool

An all-purpose measurement tool with the innovative **Donut Mechanism**.

This is the best choice for all the bike shop owners.

Set it on the bike in any position quickly and provide a trial cycling for the consumer. Then define the stem with right spec for consumer.

RETAIL

Characteristic

- 1 To measure the height from the ground to the handle bar center.
 Means angle measurement.
 IS-23 offers 70~130degrees as a angle adjustment range.
- 2 To measure the distance from fork steerer tube to the handle bar center
 Means extension measurement.
 IS-23 offers 60~150mm as a extension adjustment range.
- 3 IS-23 is not just a measure tool, but also offering a trial cycling to define a stem with custom built spec.

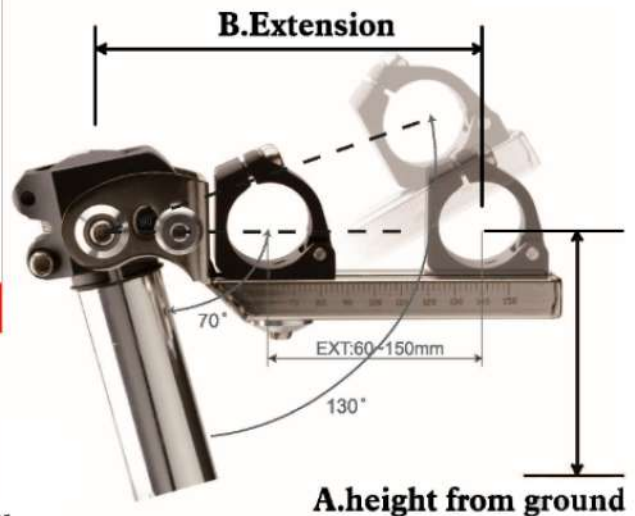

STEERING COMPONENTS

Pedal



BB09005

BMX PEDAL (CASTING)

Body : Alloy
Spindle : Steel
Size : 98 x 100 mm



BB09006

BMX PEDAL (CASTING)

Body : Alloy
Spindle : Steel
Size : 99 x 102 mm



BB09007

BMX PEDAL (CASTING)

Body : Alloy
Spindle : Steel
Size : 99 x 106 mm



BB09008

PLASTIC BIKE PEDAL

Body : P.P.
Cage : AL or Steel
Spindle : Steel
Size : 90 x 70 mm



BB09501

PLASTIC BIKE PEDAL

Spindle : Steel
Body : PP
Size : 96 x 77 mm



BB09502

PLASTIC BIKE PEDAL

Spindle : Steel
Body : PP
Size : 99 x 80 mm



BB09503

PLASTIC BIKE PEDAL

Spindle : Steel
Body : PP
Size : 97 x 95 mm
Toe Clip Attachable



BB09504

PLASTIC BIKE PEDAL

Spindle : Steel
Body : PP
Size : 95 x 85 mm



BB09505

PLASTIC BIKE PEDAL

Spindle : Steel
Body : PP
Size : 82 x 70 mm



BB15011

PEDAL NON-SLIP BOLTS

Material : 10B21 Alloy Steel
Size : M4 x 4L & 6L
Weight : 0.65g
Torque : 3N-m
Color : Red/Gold/Blue/
Green/Pink/Orange



BB15012

PEDAL NON-SLIP BOLTS

Material : 10B21
Size : M4 x 6L
Weight : 1.0g
Torque : 3N-m
Color : Black/Silver



BB15013

PEDAL NON-SLIP BOLTS

Material : AL 7075
Size : M4 x 6L
Weight : 0.4g
Torque : 3N-m
Color : Red/Gold/Blue/
Green/Pink/Orange

Bar Ends



BB01001

BAR END LIGHTS, ROUND

Battery : CR1632 battery

Cap Shape : ROUND

Cap Diameter: 25mm

Weight: 20g



BB01009

BAR END LIGHTS, ARC

Battery : CR1632 battery

Cap Shape : ARC

Cap Diameter: 28mm

Weight: 20g



BB01010

BAR END LIGHTS, SLOPED

Battery : CR1632 battery

Cap Shape : SLOPED

Cap Diameter: 28mm

Weight: 20g



BB01011

BAR END LIGHTS, ROUND

Battery : L1130

Cap Shape : ROUND

Cap Diameter: 24mm

Weight: 34g



BB22001

BAR END PLUGS, FLAT

Cap Shape : FLAT

Cap Diameter: 25mm

Weight: 32g



BB22002

BAR END

Material : 100% Carbon Fiber

Texture :

3K/UD/Marble/Others

Finish: Glossy/Matt

Weight: 59g /pair



BB22003

BAR END

Material : 100% Carbon Fiber

Texture :

3K/UD/Marble/Others

Finish: Glossy/Matt

Weight: 71g /pair



BB22004

BAR END

Material : 100% Carbon Fiber

Texture :

3K/UD/Marble/Others

Finish: Glossy/Matt

Weight: 69g /pair



BB22005

ALLOY BAR END PLUG

Material : Aluminum

Logo can be customized.

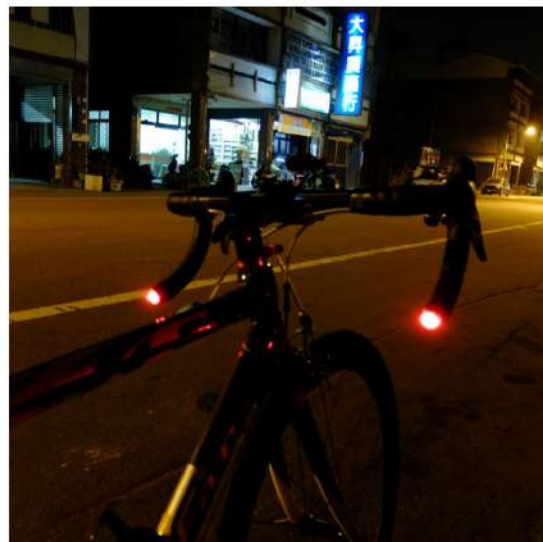

STEERING COMPONENTS

Shifter Cable Kit



BB07501

Shifter Cable Kit

Specification

PART NO.	USE	WIRE DIA	LENGTH	END FITTING	MATERIAL / FINISH	Qty	Note	OD DIA	
BB07001-1	SHIFTER	1.1 mm	2.1 M	SHIMANO	SS 304/ GROUND	2	19 STRANDS	4 mm	
BB07001-2					SS 304/ GROUND POLISH				
BB07001-3					CAMPAGNOLO				SS 304/ GROUND POLISH FILM
BB07001-4					UNIVERSAL				SS 304/ GROUND TEFLON
BB07001-5					SS304/ GROUND NANO COATED				

Inner wire

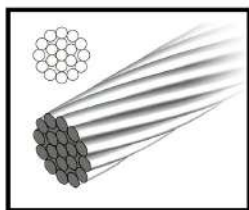

Basic



Ground



Ground Polished



Ground Polished Film



Ground Teflon



Ground Nano Coated

End Fitting

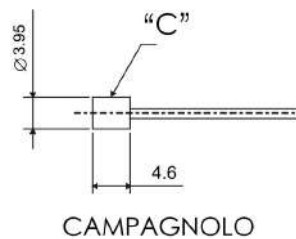
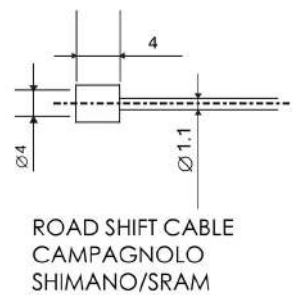
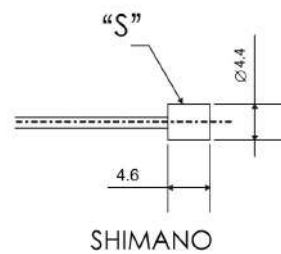

Housing

- PE Liner
- PP Outer Material
- 2P High strength steel for Brake
- SP High strength steel for Shifter

Brake Cable Kit



BB07502

Brake Cable Kit

Specification

PART NO.	USE	WIRE DIA	LENGTH	END FITTING	MATERIAL / FINISH	Qty	Note	OD DIA
BB07002-1	BRAKE	1.5 mm	1.7 M	MTB	SS 304/ GROUND	2	19 STRANDS	5 mm
BB07002-2				SHIMANO	SS 304/ GROUND POLISH			
BB07002-3				CAMPAGNOLO	SS 304/ GROUND POLISH FILM			
BB07002-4				UNIVERSAL	SS 304/ GROUND TEFLON			
BB07002-5					SS304/ GROUND NANO COATED			

Inner wire



Basic



Ground



Ground Polished



Ground Polished Film



Ground Teflon



Ground Nano Coated

End Fitting

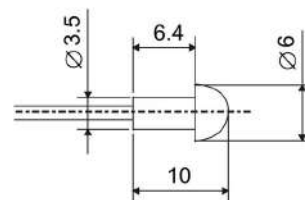

SHIMANO
6 x 10

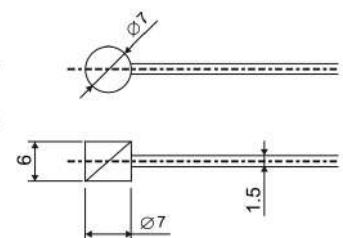

MTB SPEC

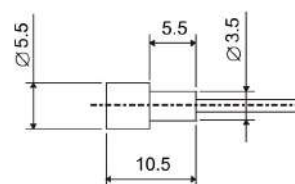

CAMPAGNOLO
6 x 10



STEERING COMPONENTS

Cable Donuts / C Clip



BB20001

RUBBER CABLE DONUT

Material	Rubber
Size	1.5mm & 1.1mm
Weight	0.4g/pc
Color	Red/Blue/Gold/Green /Orange/Black/White/Pink



BB20002

ALUMINUM CABLE DONUT

Material	AL 6061 + Rubber
Size	1.5mm & 1.1mm
Weight	0.5g/pc
Color	Anodized



BB20003

PLASTIC HOSE C CLIP

Material	Plastic
Size	MTB
Weight	0.4g/pc
Color	Red/Blue/Gold/Black



BB20004

ALUMINUM HOSE C CLIP

Material	AL 6061
Size	MTB
Weight	0.5g/pc
Color	Anodized



BB20005

CABLE PROTECTOR SLEEVE

Material	TPR
Weight	1.0g/pc
Color	Red/Gold/Blue/ Black/White



BB20006

CABLE END CAP for SHIFTER or BRAKE

Material	AL 6061
Size	1.2 mm/ 1.5 mm
Weight	2g
Color	Anodized

Bolts & Screws



BB15001

CHAINRING BOLT & NUTS

Material	AL 7075
Size	M8 x 6.5L
Weight	1.7g
Torque	8N-m
Color	Anodized



BB15002

BOTTLE CAGE BOLT SLOTTED

Material	AL 7075
Size	M5 x 15L
Weight	1.0g
Torque	2N-m
Color	Anodized



BB15003

BOTTLE CAGE BOLT

Material	AL 7075
Size	M5 x 13L
Weight	0.85g
Torque	2N-m
Color	Anodized



BB15004

BOTTLE CAGE BOLT

Material AL 7075
 Size M5 x 15L
 Weight 1.0g
 Torque 2N-m
 Color Anodized



BB15005-*114

ROTOR BOLT

Material AL 7075
 Size M5 x 10.5L
 Weight 0.85g
 Torque 3N-m
 Color Anodized



BB15005-*215

ROTOR BOLT

Material SUS 302
 Size M5 x 11L
 Weight 1.95g
 Torque 6N-m
 Color Natural



BB15006

ROTOR ADJUSTMENT BOLT

Material 10B21 Alloy Steel
 Size M6 x 18L+WS
 Weight 5.65g
 Torque 8N-m
 Color ED



BB15007

V BRAKE SCREW

Material AL 6061
 Size M8 x 8L & M10 x 8L
 Weight M8-2.0g ; M10-2.5g
 Torque 3N-m
 Color Anodized



BB15008

STEM BOLT

Material SUS302
 Size M5 x 20L+WS
 Weight 4.1g
 Torque 8N-m
 Color Natural



BB15009-*218

STEM BOLT W/ WASHER

Material SCM435
 Size M5 x 18L
 Weight 4.0g
 Torque 8N-m
 Color ED



BB15009-*229

STEM BOLT W/ WASHER

Material SUS302
 Size M6 x 20L+WS
 Weight 6.0g
 Torque 8N-m
 Color Natural



BB15010-*320

HEADSET CAP BOLT

Material 10B21
 Size M6 x 30L
 Weight 7.5g
 Torque 8N-m
 Color Natural



STEERING COMPONENTS



BB15010-*120

HEADSET CAP BOLT

Material AL 7075
 Size M6 x 30L
 Weight 2.7g
 Torque 7N-m
 Color Anodized

KT COLOR CHART



Barrel Adjuster



BB15505

BRAKE LEVER BARREL ADJUSTER

Material AL 6061
 Size M10 x 15L
 Weight 6.8g
 Color Anodized



BB15506

BRAKE LEVER BARREL ADJUSTER

Material AL 6061
 Size M10 x 12L
 Weight 6.5g
 Color Anodized



BB15512

CABLE CARRIER & STRADDLE WIRE

Material Steel



BB15507

DERAILEUR BARREL ADJUSTER

Material AL 6061
 Size M5
 Weight 3.5g
 Color Anodized



BB15508

DERAILEUR BARREL ADJUSTER

Material AL 6061
 Size M5
 Weight 2.5g
 Color Anodized



BB15509

DERAILEUR BARREL ADJUSTER

Material Steel screw /Plastic Cap
 Size M5
 Weight 3.5g
 Color Black

Valve Caps



BB15501

VALVE CAP

Material AL 6061
 Size Schrader
 Weight 2.0g
 Color Anodized



BB15503

DUAL PURPOSE VALVE CAP

Material AL 6061
 Size Presta & Schrader
 Weight 1.2g
 Color Anodized



BB15504

PRESTA VALVE ADAPTOR

Material AL 6061
 Size Presta to schrader
 Weight 1.2g
 Color Anodized



BB15511

VALVE CAP Material

AL 6061
 Size Presta
 Weight 2.0g
 Color Anodized



BB15513

VALVE CAP

Material AL 6061
 Size Presta
 Weight 1.2g
 Color Anodized



BB15514

VALVE CAP Material

AL 6061
 Size Presta
 Weight 0.6g
 Color Anodized



BB15515

VALVE CAP

Material AL 6061
 Size Schrader & Presta
 Weight 2.0g
 Color Anodized



BB15516

VALVE CAP

Material AL 6061
 Size Schrader
 Weight 1.0g
 Color Anodized



BB15517

VALVE CAP

Material AL 6061
 Size Schrader
 Weight 2.2g
 Color Anodized



BB15519

PRESTA VALVE EXTENDER

Material AL 6061
 Size 30 / 50 / 70 mm
 Weight 2.2g (50MM)



BB15520

PRESTA VALVE EXTENDER

Material AL 6061
 Size 30 / 50 / 70 mm
 Weight 2.0g (50MM)



BB15521

PRESTA VALVE EXTENDER

Material AL 6061
 Size 30 / 50 / 70 mm
 Weight 1.8g (50MM)

